



PolyWorks®

10.1

PolyWorks® 10.1 Delivers Optimized Sheet Metal Workflows

Intelligently Manage the Thickness of Sheet Metal CAD Models

- Specify a thickness value for individual CAD models
- Enable a virtual material side or simulate a solid model in one mouse click
- Easily create or project surface comparison points, boundary comparison points, features, and reference points on the original or *virtual* CAD model surface
- Let PolyWorks figure out if scan data acquisition or tactile probe measurement is performed with respect to the original or the virtual CAD model surface

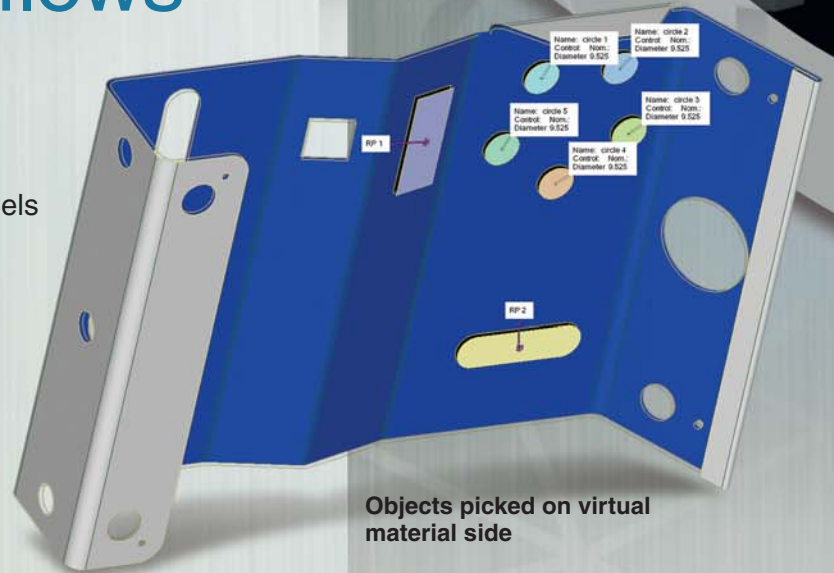

Objects picked on virtual material side



Boundary scanning

Outstanding New Capabilities for Sheet Metal Inspection

- Laser scan trimmed edge boundaries and capture data points in real time on sheet metal outer boundaries and holes
- Benefit from new and improved analysis techniques for trimmed and hemmed edges
- Improve your inspection reports by using new annotation positioning and drawing methods dedicated to sheet metal surface and boundary inspection

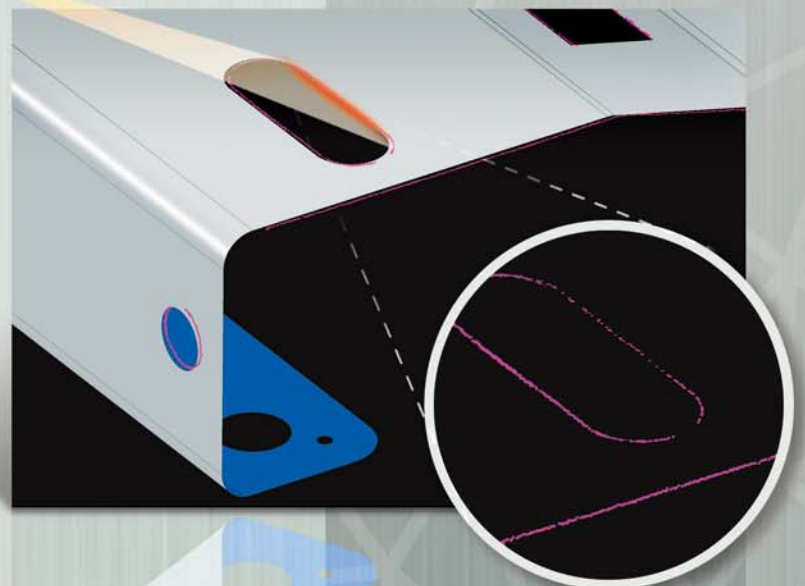

The Most Comprehensive Point Cloud Engineering Solution for Industrial Manufacturing Applications

- More efficient laser scanning experience with improved user interface and automatic management of connection and disconnection for scanner and tactile probe devices
- New capability to edit feature compensation parameters after probing
- New *curvature-sensitive* point cloud smoothing method that preserves the radius of sharp fillets
- Major improvements in native CAD data handling, including import of layers, assembly parts, features, dimensions, and **GD&T**
- Improved feature dimensioning, including several new and revised dimensions, as well as a new Ellipse object
- New virtual snapshots and vector graphics that dramatically increase resolution for plotters
- New specialized hole-filling technology for filleted areas
- New curve network analysis tool that shows the nature and location of incorrect or inappropriate curve configurations for NURBS surface fitting
- New method for fitting N-sided trimmed NURBS surfaces

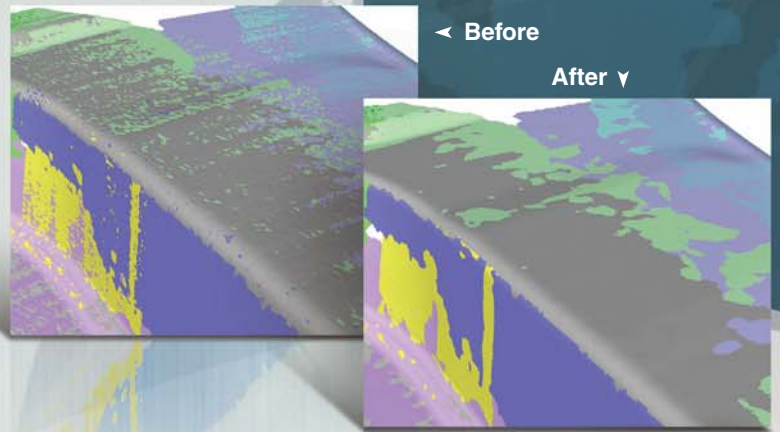

Smoothing results

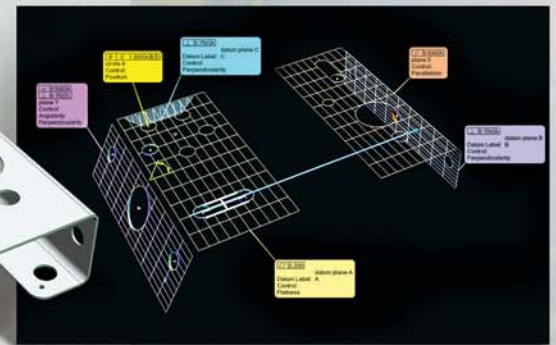
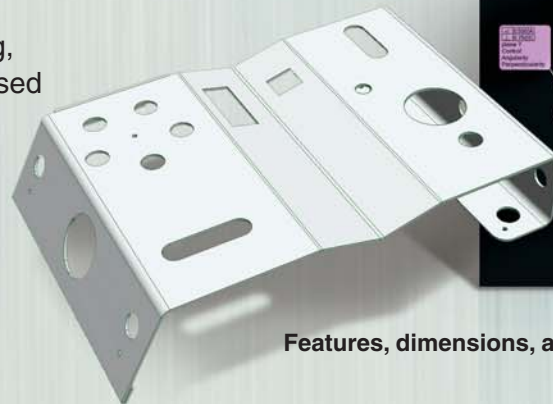

Features, dimensions, and GD&T import from native CAD data

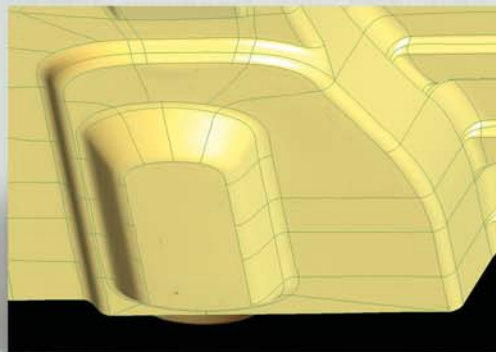

N-sided NURBS patch

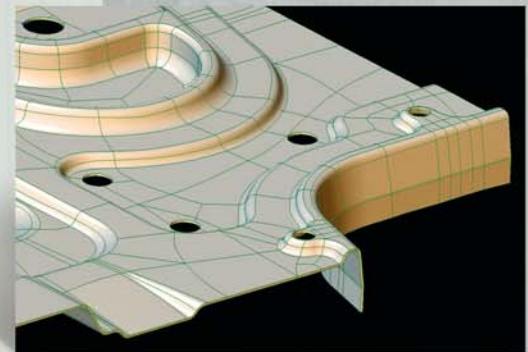

Thickness and hole cutting



HEAD OFFICE
 InnovMetric Software Inc.
 2014, Cyrille-Duquet, Suite 310
 Québec QC Canada G1N 4N6
 Tel. [418] 688-2061
 Fax [418] 688-3001
 info@innovmetric.com
www.innovmetric.com/buy

Detroit (MI)
 Los Angeles (CA)
 Salisbury (NC)
 Shanghai (China)
 Lindau (Germany)
 Partner office in Europe:
 Duwe-3d AG



Contact your local PolyWorks representative for more information

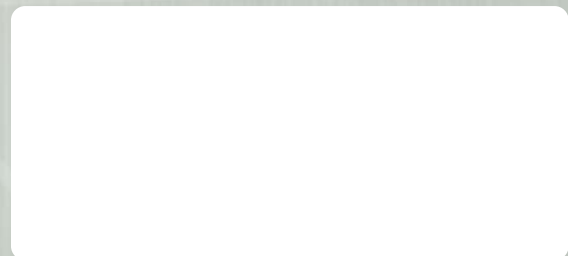

SmartGD&T™

